

Engineering Specification

Job Name _____
 Job Location _____
 Engineer _____
 Approval _____

Contractor _____
 Approval _____
 Contractor's P.O. No. _____
 Representative _____

LEAD FREE*

Series LF3002 Dielectric Unions

Sizes: 1/2" x 3/8" — 1" x 3/4"

Series LF3002 dielectric unions feature a female iron pipe thread to reduced solder connection. These unions are designed to be installed between pipe made from dissimilar metals to prevent accelerated corrosion and deterioration in the piping system due to galvanic and stray current. The LF3002 features Lead Free* construction to comply with Lead Free* installation requirements.

Features

- Female iron pipe thread to reduced solder connection
- Designed and manufactured to the highest quality standards
- Factory audit tested to confirm 600V dry line performance without flashover
- Rated to 180°F (82°C) at 250psi (17.2 bar)

Specifications

A dielectric union shall be installed where indicated on the plans. The union shall feature a female iron pipe thread to reduced solder connection. The dielectric union shall be constructed using Lead Free* materials. Inquire with governing authorities for local installation requirements. The dielectric union shall be a Watts Series LF3002.

Materials — Dimensions — Weights

Call customer service if you need assistance with technical details.

SIZE	MATERIALS					DIMENSIONS				WEIGHT	
	TAIL PIECE	ADAPTER †	NUT †	INSULATOR	GASKET	A		B		oz.	gm
<i>in.</i>						<i>in.</i>	<i>mm</i>	<i>in.</i>	<i>mm</i>		
1/2 x 3/8	Lead Free Brass	Steel	Steel	Polysulfone	Buna-N	1 1/2	38	1 7/8	48	5.8	164
3/4 x 1/2	Lead Free Brass	Steel	Steel	Polysulfone	Buna-N	1 5/8	41	1 7/8	48	7.2	204
1 x 3/4	Lead Free Brass	Steel	Steel	Polysulfone	Buna-N	2 1/8	48	2 1/2	64	10.1	286

† Steel adapter and nut are zinc plated

NOTICE

The information contained herein is not intended to replace the full product installation and safety information available or the experience of a trained product installer. You are required to thoroughly read all installation instructions and product safety information before beginning the installation of this product.

Watts product specifications in U.S. customary units and metric are approximate and are provided for reference only. For precise measurements, please contact Watts Technical Service. Watts reserves the right to change or modify product design, construction, specifications, or materials without prior notice and without incurring any obligation to make such changes and modifications on Watts products previously or subsequently sold.



LF3002



Standards

Meet federal specifications for tensile strength and thread end connections

Pressure — Temperature

Maximum Pressure: 250psi (17.2 bar)

Maximum Temperature: 180°F (82°C)

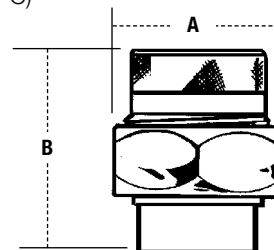

NOTICE

Inquire with governing authorities for local installation requirements

*The wetted surface of this product contacted by consumable water contains less than 0.25% of lead by weight.



USA: T: (978) 689-6066 • Watts.com

Canada: T: (888) 208-8927 • Watts.ca

Latin America: T: (52) 55-4122-0138 • Watts.com