

C400NBF, C400ZBF

SIZE		DIMENSIONS										WEIGHT			
in.	in.	G	mm	H	mm	I	mm	J	mm	M	mm	P	mm	C400N, C400Z	
														lb	kg
2½	23	584	584	23	584	15½	394	9½	241	19¾	502	11 ¹³ / ₁₆	300	67	30
3	24	610	610	24	610	16 ⁵ / ₁₆	414	10 ¹ / ₁₆	256	21¼	540	12 ¹ / ₈	308	70	32
4	35 ⁵ / ₈	905	905	35 ⁵ / ₈	905	17 ⁷ / ₁₆	437	10 ¹⁵ / ₁₆	279	23½	597	12 ⁵ / ₈	321	87	39
6	35¼	895	895	35¼	895	20½	521	13½	343	27¼	692	15	382	160	73

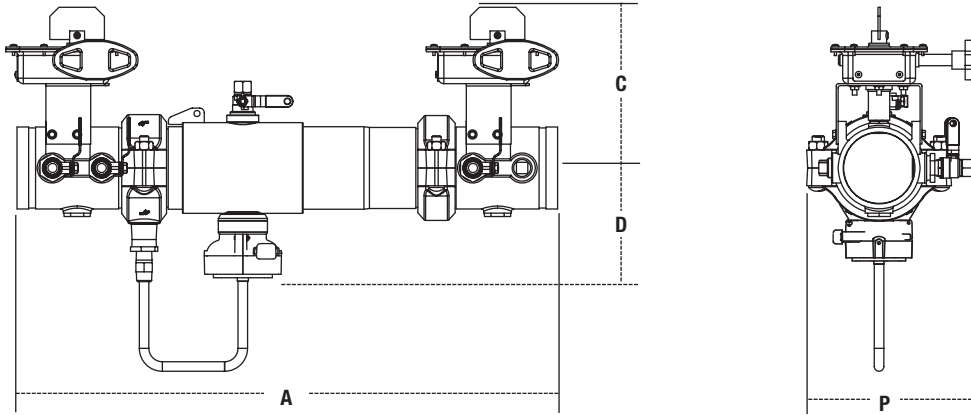

C400 BFG

SIZE		DIMENSIONS					WEIGHT				
in.	in.	A	mm	C	mm	D	mm	P	mm	lb	kg
4	29	737	737	7¾	197	6 ⁵ / ₈	162	9½	241	66	30
6	36½	927	927	9 ¹ / ₁₆	246	7 ⁷ / ₁₆	189	14¼	362	122	55

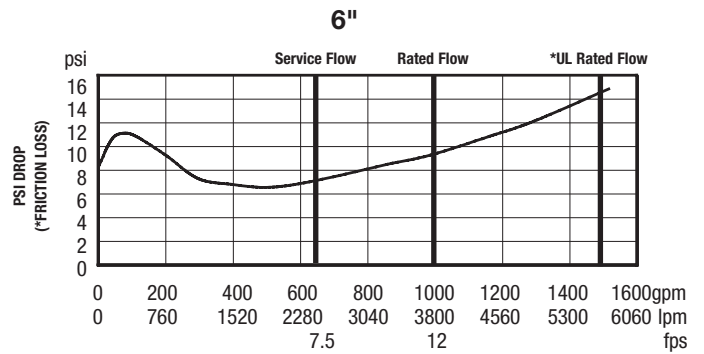
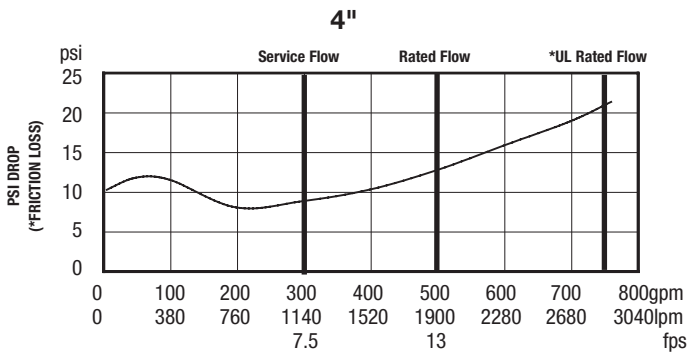

Capacity

UL Classified and FM Approved certified flow characteristics.
 N and Z flow characteristics collected using butterfly shutoff valves.

— Horizontal — N - Pattern - - - - Z - Pattern

Flow capacity chart identifies valve performance based upon rated water velocity up to 25 fps.

- Service Flow is typically determined by a rated velocity of 7.5 fps based upon Schedule 40 pipe.
- Rated Flow identifies maximum continuous duty performance determined by AWWA.
- UL Flow Rate is 150% of Rated Flow and is not recommended for continuous duty.
- AWWA Manual M22 (Appendix C) recommends that the maximum water velocity in services be not more than 10 fps.

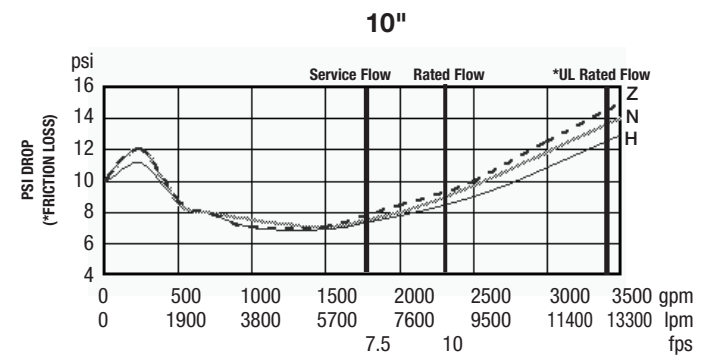
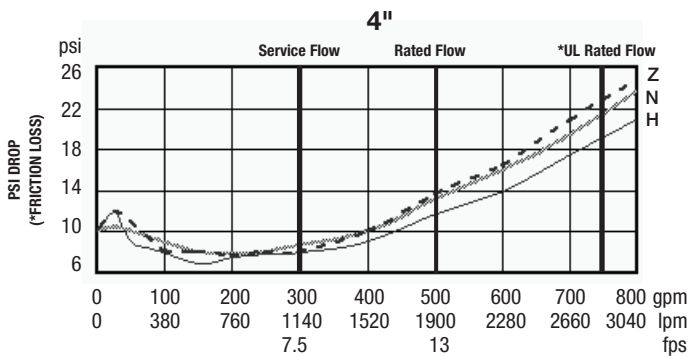
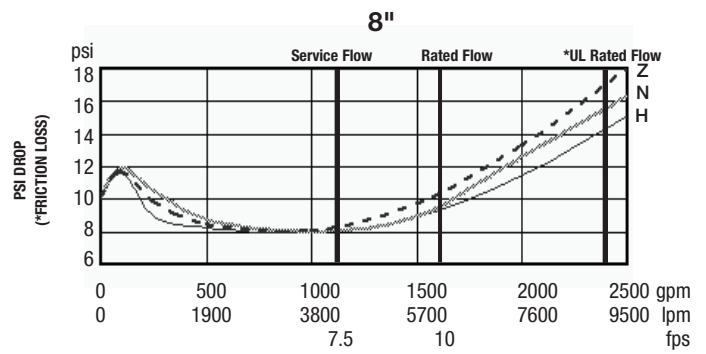
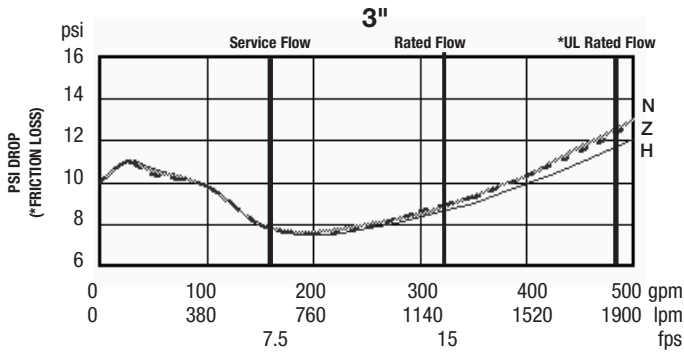
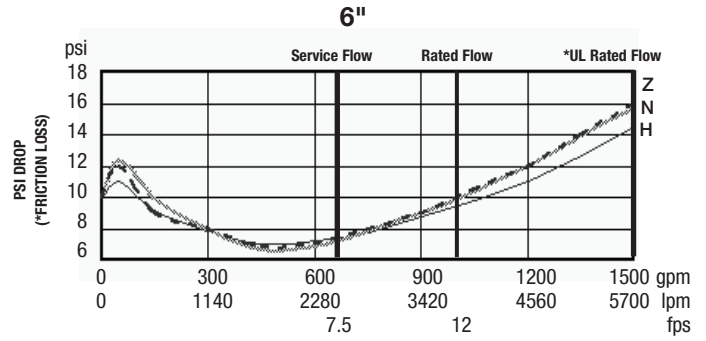
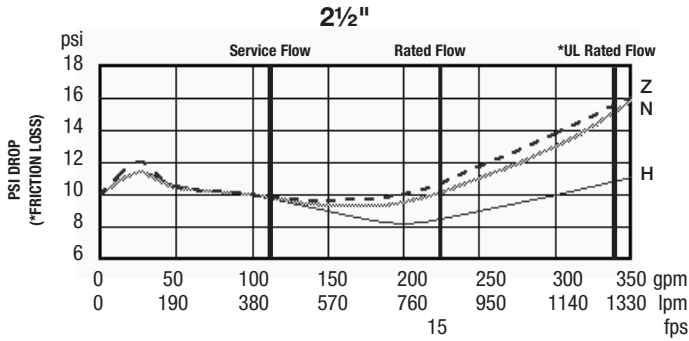

A WATTS Brand

USA: Backflow T: (978) 689-6066 • F: (978) 975-8350 • AmesFireWater.com
 USA: Control Valves T: (713) 943-0688 • F: (713) 944-9445 • AmesFireWater.com
 Canada: T: (888) 208-8927 • F: (905) 481-2316 • AmesFireWater.ca
 Latin America: T: (52) 55-4122-0138 • AmesFireWater.com