

Installation, Operation and Maintenance Manual

Series W6000

3-Piece Sanitary Ball Valves with
Tri Clamp and Tube Weld Connections

Models: W6200, W6400



W6200



W6400

Important Safety Information



Verify system is fully depressurized and drained prior to installation or service.



Use appropriate personal protective equipment (PPE). Do not exceed valve pressure, temperature, or media compatibility limits.



Follow all applicable local safety and sanitary regulations.

⚠ WARNING



Please read carefully before proceeding with installation. Your failure to follow any attached instructions or operating parameters may lead to the product's failure.



Keep this Manual for future reference.

⚠ WARNING

Local building or plumbing codes may require modifications to the information provided. You are required to consult the local building and plumbing codes prior to installation. If the information provided here is not consistent with local building or plumbing codes, the local codes should be followed. This product must be installed by a licensed contractor in accordance with local codes and ordinances.

NOTICE

Follow the guidelines listed here for proper installation, operation, and maintenance.

General Information

Watts Ball Valves are tested at the factory to ensure performance and air tightness. Valves are packaged in accordance with Watts specifications, unless the customer has special requirements.

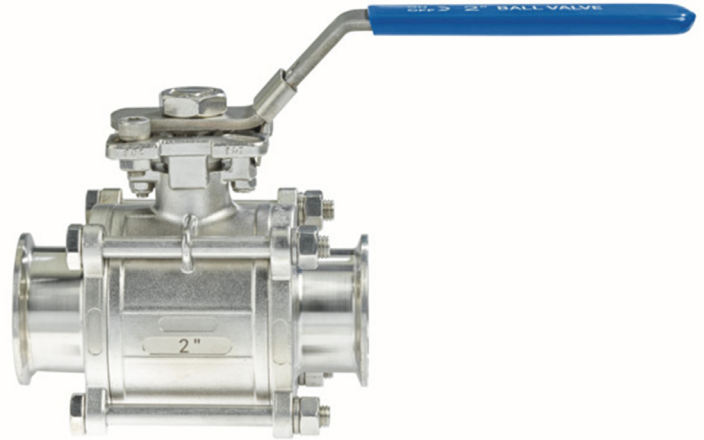

W6400



W6200

* See Watts.com for available repair kits.

Installation Instructions

Pre-Installation

1. Before installing the valve, be sure to check its appearance to make sure there is no damage.
2. Before installation, determine if reasonable reinforcement is required based on the overall condition and weight of the valve.
3. Make sure that the valves of the selected material are suitable for basic installation conditions, in particular the working pressure and the temperature of the working medium.

Series W6000 Ball Valves:

Pressure Range: 14.5-145 psi

Operating Temperature: -76°F - 302°F

Orientation

1. Valves can be installed vertically or horizontally.
2. There is no restriction on the direction of media flow

Connection

1. Install using appropriate sanitary connections (tri-clamp, tube weld end, etc.).
2. Use properly sized sanitary gaskets and tighten clamps evenly to avoid leakage.

Operation

3. The technical condition and function of the valve should be checked before starting the valve and throughout the period of use.
4. The sealing ring bears the largest force in the whole valve. Mechanical or chemical stress and wear can occur on the seal due to the medium during operation, so regular inspections should be carried out, and inspection intervals are to be determined based on utilization and/or relevant regulations.
5. If it is necessary to perform online sterilization on the ball valve, steam can be connected to achieve this goal. The method is to open the ball valve, start steam sterilization, and perform online sterilization on the valve chamber, sealing ring, and valve cover.

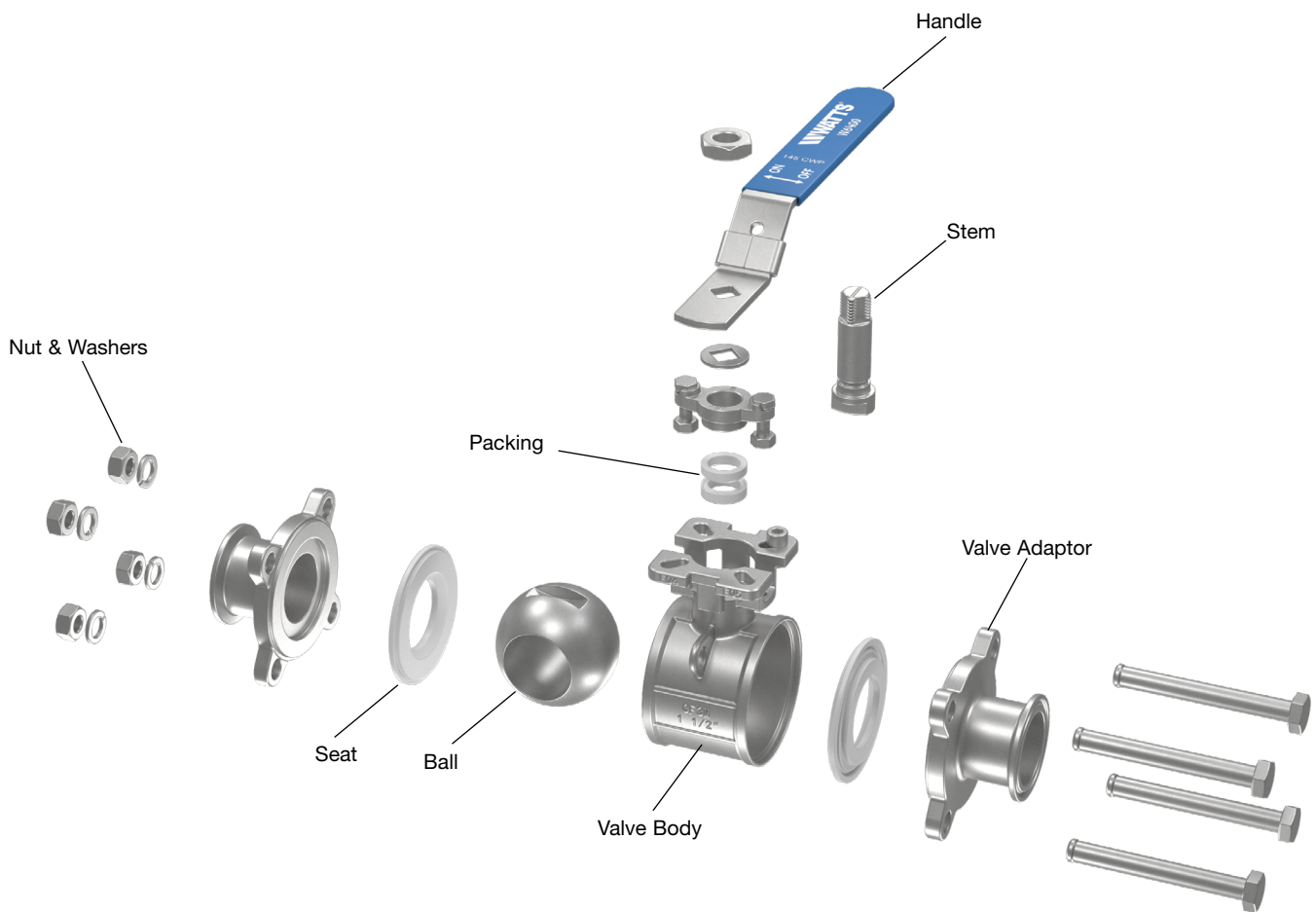

Maintenance

⚠ WARNING

Need for Periodic Inspection/Maintenance: This product must be tested periodically in compliance with local codes, but at least once per year or more as service conditions warrant. All products must be retested once maintenance has been performed. Corrosive water conditions and/or unauthorized adjustments or repair could render the product ineffective for the service intended. Regular checking and cleaning of the product's internal and external components helps assure maximum life and proper product function.

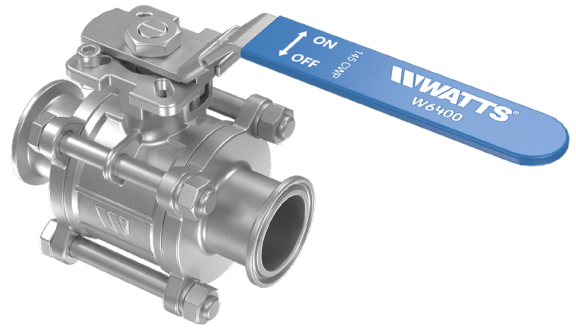

Figure 1

Routine Inspection

1. Inspect for leakage, wear or performance issues
2. Monitor for chatter or backflow.
3. Check for buildup or fouling.

NOTICE

When disassembling heavy valves, there could be a hazard of free drop. Use a traveling crane to secure the valve and remove it from the equipment or pipe. Place the valve on a clean, padded floor or padded work surface.

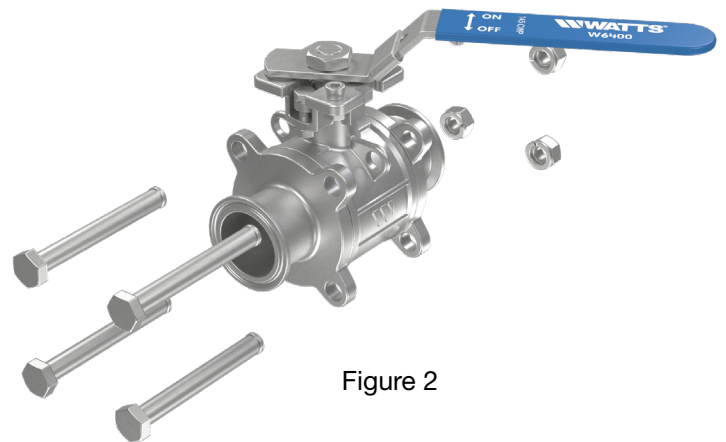

Figure 2

Disassembly and Maintenance

1. Confirm that the equipment is shut down and that there is no medium and no pressure in the valve.
2. With the valve in the half-open position, remove the connecting bolts. (Figure 2)
3. Remove both sides of the valve cover and take out the sealing valve seat; check the wear and tear of the sealing seat. If there is internal leakage or external leakage at the connection position of the valve body and valve adaptor, replace the sealing seat. (Figure 3)
4. When the valve is in the closed state, take out the ball and check its wear. Internal leakage is related to ball wear. If there is any obvious wear or defect on the surface that could be observed visually, it needs to be polished; if it cannot be repaired, the valve shall be replaced. (Figure 4)
5. Remove the handle nut, remove the handle, and remove the lock nut on the gland.
6. Remove the stem and take out the packing. Check packing and stem for wear. Replace valve if worn.
7. Reverse the above steps to install. Handle with care. Pay attention to the alignment of the valve stem when installing the valve core. If the switch is in the wrong position, it should be removed and reinstalled.

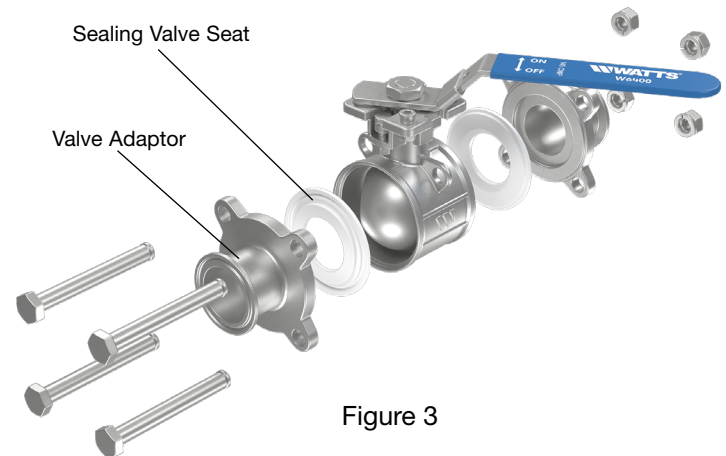

Figure 3



Figure 4

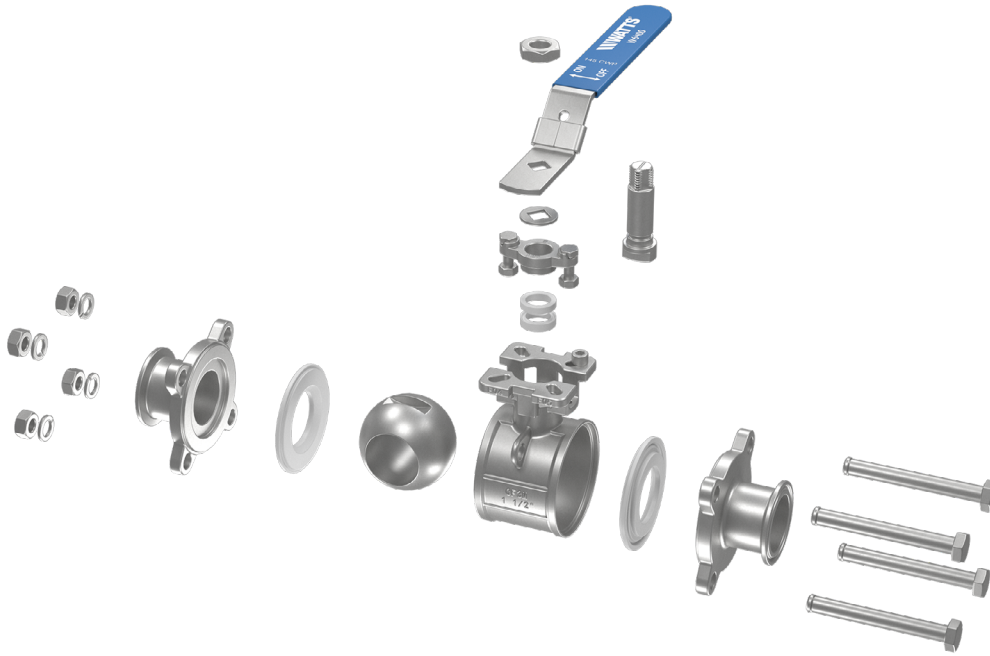

Figure 5

Disassembly & Cleaning

1. Disassemble all accessories and place them on a clean cloth in sequence without stacking them.
2. Wipe along the valve body, valve cover, valve seat, and inner cavity, repeating 360 degrees in clockwise and counterclockwise directions, ensuring that the cloth is folded between each stroke.
3. Throw the used wipes into a suitable bin.
4. Repeat steps 1 to 3 with a new clean cloth.
5. If necessary, repeat steps 1 to 3 several times.
6. Drying: Before reusing the ball valve, it should be dried first.
7. Inspection: Every time the ball valve is cleaned, the sealing valve seat and ball core must be checked for damage. If there is any damage, it must be replaced immediately.

NOTICE

According to the user's on-site management regulations, suitable alcohol should be used to clean the valve body, valve cover and inner cavity. Wipe the inner and outer surfaces of the valve seat, and remove all potential traces of residual products. Please follow the following steps for specific operations.

NOTICE

Inquire with governing authorities for local installation requirements

Watts Regulator Co. (the "Company") warrants each product to be free from defects in material and workmanship under normal usage for a period of one year from the date of original shipment. In the event of such defects within the warranty period, the Company will, at its option, replace or recondition the product without charge.

THE WARRANTY SET FORTH HEREIN IS GIVEN EXPRESSLY AND IS THE ONLY WARRANTY GIVEN BY THE COMPANY WITH RESPECT TO THE PRODUCT. THE COMPANY MAKES NO OTHER WARRANTIES, EXPRESS OR IMPLIED. THE COMPANY HEREBY SPECIFICALLY DISCLAIMS ALL OTHER WARRANTIES, EXPRESS OR IMPLIED, INCLUDING BUT NOT LIMITED TO THE IMPLIED WARRANTIES OF MERCHANTABILITY AND FITNESS FOR A PARTICULAR PURPOSE.

The remedy described in the first paragraph of this warranty shall constitute the sole and exclusive remedy for breach of warranty, and the Company shall not be responsible for any incidental, special or consequential damages, including without limitation, lost profits or the cost of repairing or replacing other property which is damaged if this product does not work properly, other costs resulting from labor charges, delays, vandalism, negligence, fouling caused by foreign material, damage from adverse water conditions, chemical, or any other circumstances over which the Company has no control, including without limitation the use of incompatible chemicals and lubricants. This warranty shall be invalidated by any abuse, misuse, misapplication, improper installation or improper maintenance or alteration of the product, as well as any failure to install, operate or maintain the product in strict accordance and adherence with the product's operating documentation and manuals.

Some States do not allow limitations on how long an implied warranty lasts, and some States do not allow the exclusion or limitation of incidental or consequential damages. Therefore the above limitations may not apply to you. This Limited Warranty gives you specific legal rights, and you may have other rights that vary from State to State. You should consult applicable state laws to determine your rights. **SO FAR AS IS CONSISTENT WITH APPLICABLE STATE LAW, ANY IMPLIED WARRANTIES THAT MAY NOT BE DISCLAIMED, INCLUDING THE IMPLIED WARRANTIES OF MERCHANTABILITY AND FITNESS FOR A PARTICULAR PURPOSE, ARE LIMITED IN DURATION TO ONE YEAR FROM THE DATE OF ORIGINAL SHIPMENT.**

