

Job Name _____

Contractor _____

Job Location _____

Approval _____

Engineer _____

Contractor's P.O. No. _____

Approval _____

Representative _____

LEAD FREE*



AquaLock™ Plastic Manifolds

Watts AquaLock push-to-connect Manifolds are designed and manufactured for many years of trouble free service. Produced of off white Polysulfone, a high performance thermal plastic material, the Watts AquaLock design allows for quick and easy connections without the use of installation tools.

Specifications

Connection shall be made using Watts AquaLock Plastic fitting with Integral Collet and O-Ring guide. Fitting shall be able to fully rotate under pressure and allow for easy disconnect and re-use without the use of disconnection tools. Fitting must not disassemble to disconnect.

Approvals

NSF-61, NSF-14, CSA B137.5, ASTM F877, UPC, ASSE 1061

Ratings

100psi @ 180°F (6.8 bar @ 82°C)
250psi @ 75°F (17.3 bar @ 24°C)

Example

3589-1810
35 = Plastic
89 = Single Union Body
1810 = 1" CTS x 1/2" CTS



3589



3583



3590



3584



3585



CAUTION

The polysulfone material used in the AquaLock™ fittings can be compromised by exposure to volatile organic compounds (VOC's) and caustic chemicals. Therefore, **DO NOT** expose this product to any such chemical or foreign substance, which would include exposure to the following products: **Pipe Dopes (thread sealants)**, bug sprays, lubricants, cleaners, paints, bleaches, acids, solder fluxes, plastic piping primers and cements, oxidizing agents, alkaline solutions, thinners, fuels, oil based caulks, hydrocarbons, spray foam of foaming agents (insulation).

It is also recommended that all threaded connections be made with Teflon® tape only.

NOTICE

The information contained herein is not intended to replace the full product installation and safety information available or the experience of a trained product installer. You are required to thoroughly read all installation instructions and product safety information before beginning the installation of this product.

***The wetted surface of this product contacted by consumable water contains less than 0.25% of lead by weight.**

Watts product specifications in U.S. customary units and metric are approximate and are provided for reference only. For precise measurements, please contact Watts Technical Service. Watts reserves the right to change or modify product design, construction, specifications, or materials without prior notice and without incurring any obligation to make such changes and modifications on Watts products previously or subsequently sold.



Assembly Elements

Plastic Push-to-connect Manifold

Single Side Style

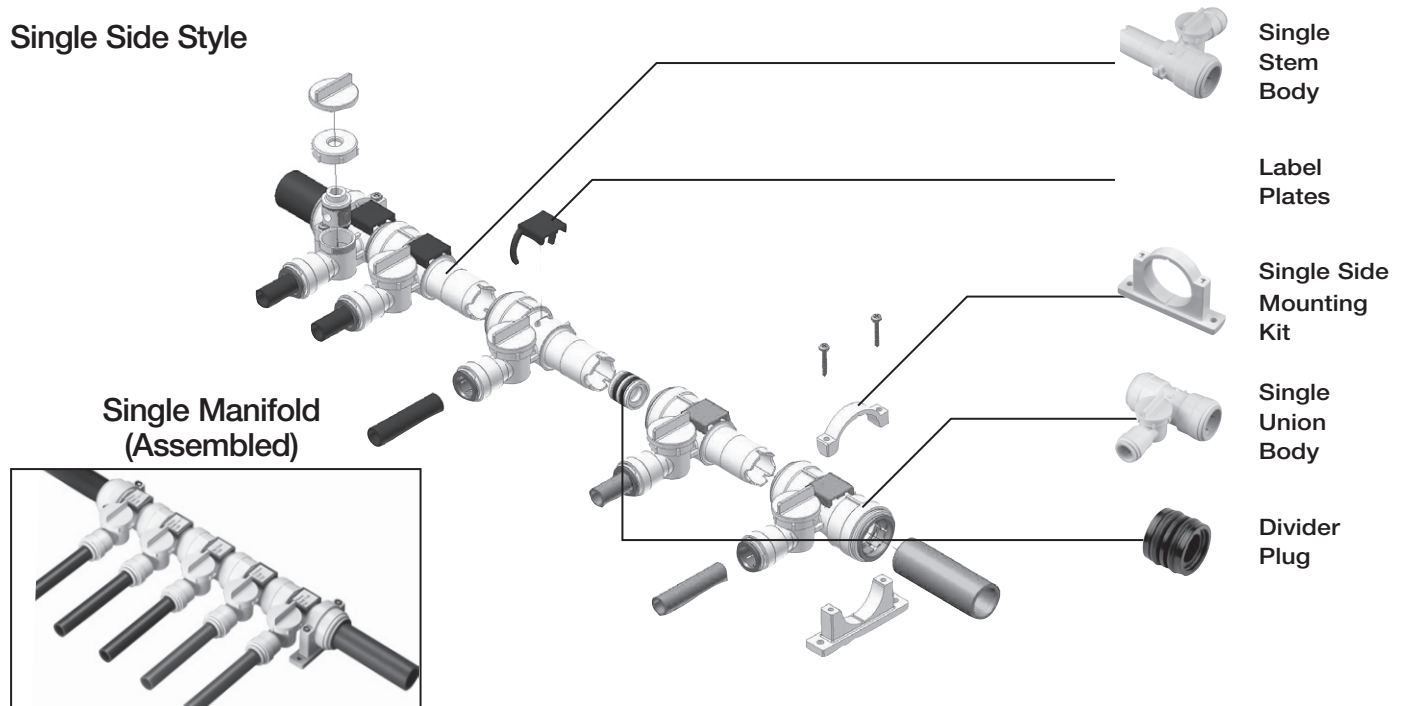

Dual Side Style

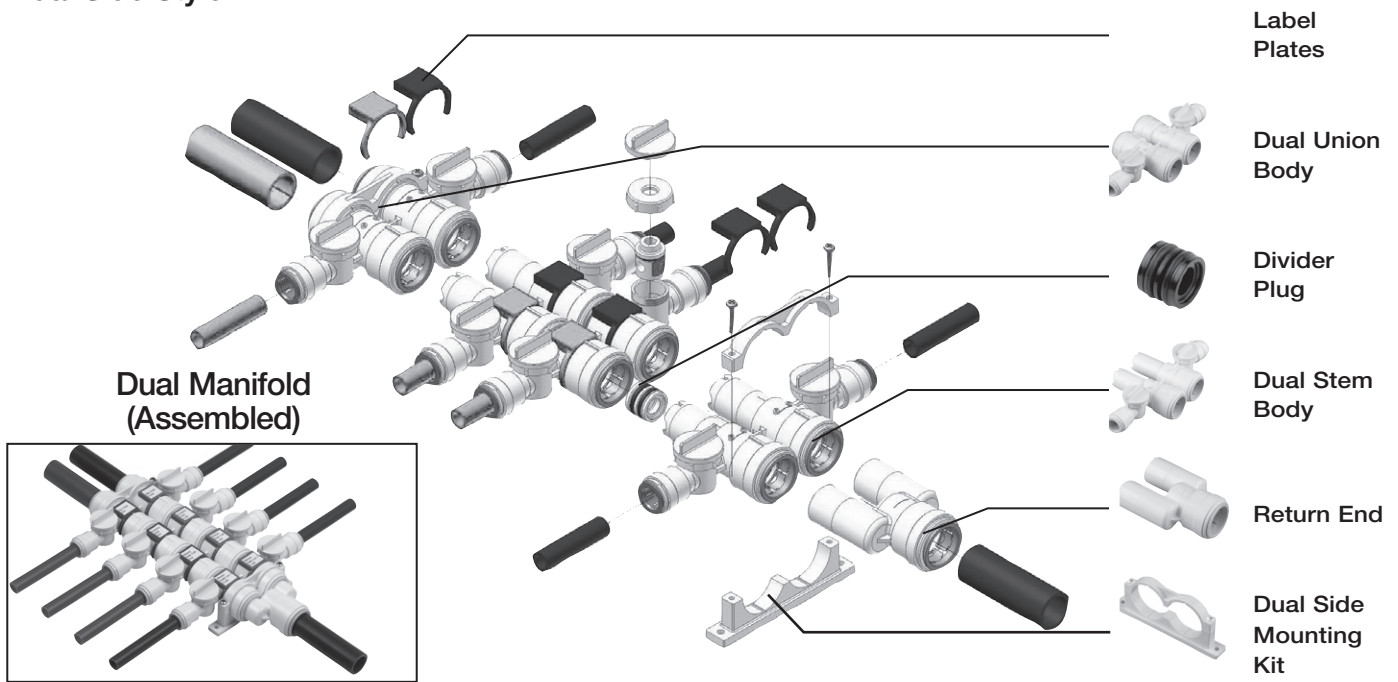

Installation Dimensions

Plastic Push-to-connect Manifold

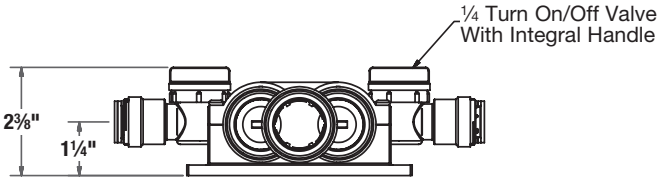
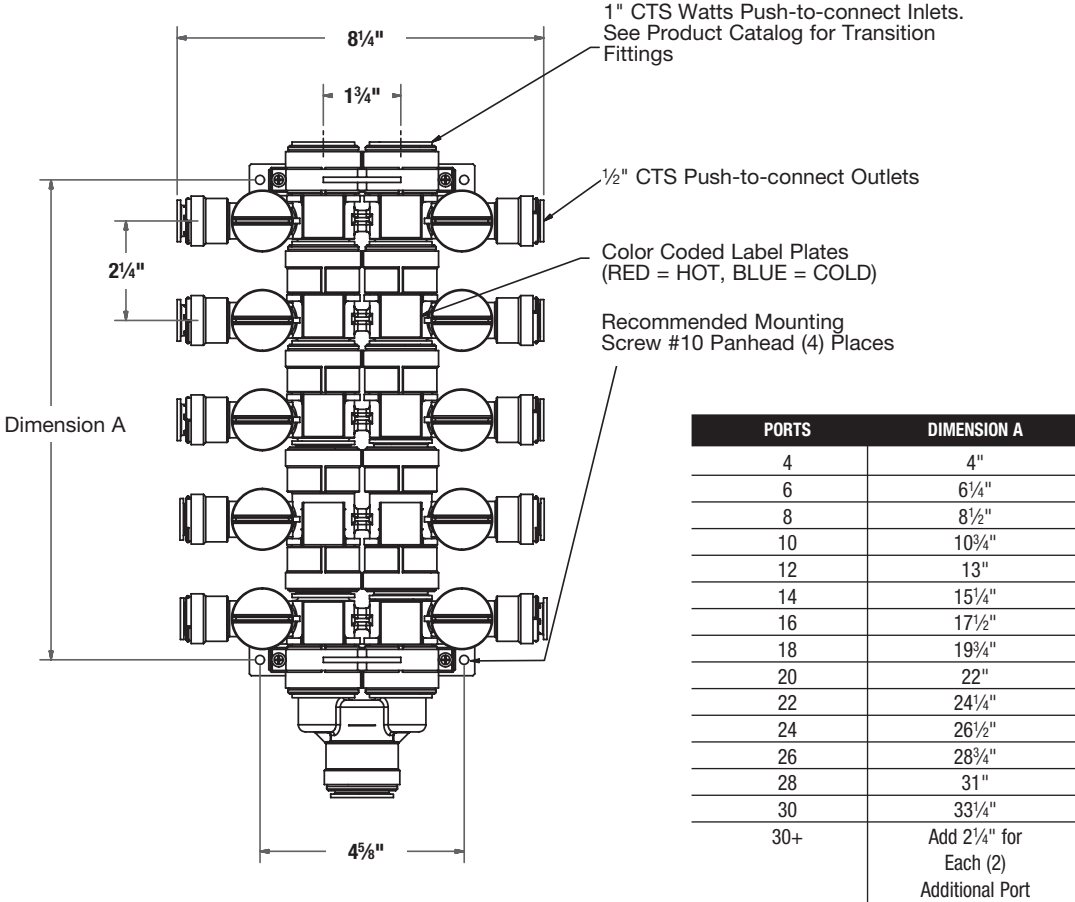

Weights – Weights are approximate

Manifolds - Single

Manifolds - Single Union Body

MODEL	ORDERING CODE	SIZE & CONNECTION	ITEM WEIGHT	
			lbs.	kg.
Package Type: Single Pack				
3589-1810	0959257	1" CTS x 1/2" CTS	3.4	1.5
Package Type: Bulk Pack				
3589-1810	81903052	1" CTS x 1/2" CTS	3.4	1.5

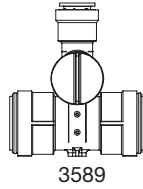

Manifolds - Single Stem Body - Right

MODEL	ORDERING CODE	SIZE & CONNECTION	ITEM WEIGHT	
			lbs.	kg.
Package Type: Single Pack				
3590-1810	0959258	1" CTS x 1/2" CTS	3	1.4
Package Type: Bulk Pack				
3590-1810CP	81903053	1" CTS x 1/2" CTS	3	1.4

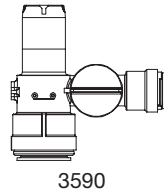

Manifolds - Single Stem Body - Left

MODEL	ORDERING CODE	SIZE & CONNECTION	ITEM WEIGHT	
			lbs.	kg.
Package Type: Single Pack				
3591-1810	0959259	1" CTS x 1/2" CTS	3	1.4
Package Type: Bulk				
3591-1810CP	81903059	1" CTS x 1/2" CTS	3	1.4

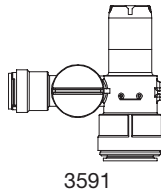

Manifold Single Side Mounting Kits

MODEL	ORDERING CODE	SIZE & CONNECTION	ITEM WEIGHT	
			lbs.	kg.
Package Type: Single Pack				
3581-18	0959260	For 35 Series	1.1	.5
Package Type: Bulk				
3581-18CP	81903044	For 35 Series	1.1	.5

3581

Manifolds - Dual

Manifolds - Dual Union Body

MODEL	ORDERING CODE	SIZE & CONNECTION	ITEM WEIGHT	
			lbs.	kg.
Package Type: Single Pack				
3583-1810	0959303	1" CTS x 1/2" CTS	6.8	3.1
Package Type: Bulk				
3583-1810CP	819903046	1" CTS x 1/2" CTS	6.8	3.1

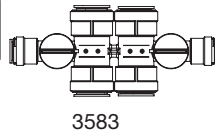

3583

Manifolds - Dual Stem Body

MODEL	ORDERING CODE	SIZE & CONNECTION	ITEM WEIGHT	
			lbs.	kg.
Package Type: Single Pack				
3584-1810	0959304	1" CTS x 1/2" CTS	6	2.7
Package Type: Bulk				
3584-1810CP	819903047	1" CTS x 1/2" CTS	6	2.7

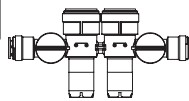

3584

Manifolds - Dual (cont'd)

Manifold Dual Side Mounting Kits

MODEL	ORDERING CODE	SIZE & CONNECTION	ITEM WEIGHT	
			lbs.	kg.
Package Type: Single Pack				
3580-18	0959295	For 35 Series	1.5	.69
Package Type: Bulk				
3580-18CP	81903043	For 35 Series	1.5	.69

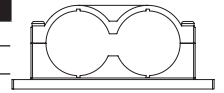

3580

Manifold Divider Plugs

MODEL	ORDERING CODE	SIZE & CONNECTION	ITEM WEIGHT	
			lbs.	kg.
Package Type: Single Pack				
3582-18	0959266	For 35 Series	0.3	.14
Package Type: Bulk				
3582-18CP	81903045	For 35 Series	0.3	.14



3582

Manifold Return Ends

MODEL	ORDERING CODE	SIZE & CONNECTION	ITEM WEIGHT	
			lbs.	kg.
Package Type: Single Pack				
3585-18	0959296	1" CTS	2.3	1.0
Package Type: Bulk				
3585-18CP	89030248	1" CTS	2.3	1.0

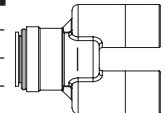

3585

Manifold Red Label Plates

MODEL	ORDERING CODE	SIZE & CONNECTION	ITEM WEIGHT	
			lbs.	kg.
Package Type: Single Pack				
3586-18	0959261	Red - For 35 and Metric	0.2	.09
Package Type: Bulk				
3586-18CP	81903049	Red - For 35 and Metric	0.2	.09

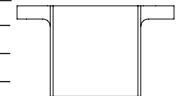

3586

Manifold Blue Label Plates

MODEL	ORDERING CODE	SIZE & CONNECTION	ITEM WEIGHT	
			lbs.	kg.
Package Type: Single Pack				
3587-18	0959262	Blue - For 35 and Metric	0.2	.09
Package Type: Bulk				
3587-18CP	81903050	Blue - For 35 and Metric	0.2	.09

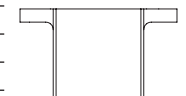

3587

Manifold Valve Repair Kits

MODEL	ORDERING CODE	SIZE & CONNECTION	ITEM WEIGHT	
			lbs.	kg.
Package Type: Single Pack				
3588-10	0650763	1/2" Spool	0.7	.32
Package Type: Bulk Pack				
3588-10CP	81903051	1/2" Spool	0.7	.32

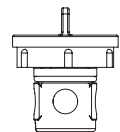

3588

